

# 529 Miniature Cartridge Fuse

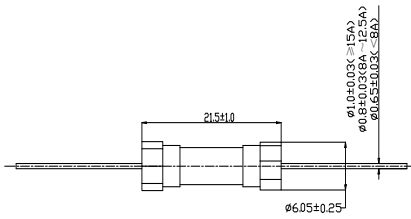

Dimensions (unit: mm)

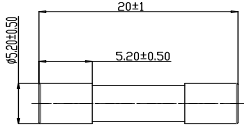

## Main Characteristics

Miniature Cartridge fuse; Fast-Acting Standard

UL248-14 IEC60127-7

## Materials

Tube: Ceramic Tube  
End Caps: Silver plated copper

## Operating Temperature

-55°C to +125°C

## Storage Conditions

+10°C to +60°C  
Relative humidity: ≤75% yearly average  
Without dew, maximum 30 days at 95%

## Vibration Resistance

24 cycles at 15 min. each (60068-6)  
10-60Hz at 0.75mm amplitude  
60-2000Hz at 10g acceleration

## Soldering Parameters

260°C. ≤5 sec (Wave Soldering)  
350°C. ≤3 sec (Hand Soldering)  
Soldering Peak:  
260°C. 10 sec. (IEC 60068-20)

## Average Time Current(I-T Curve)

Average Current Curve(I-T Curve)

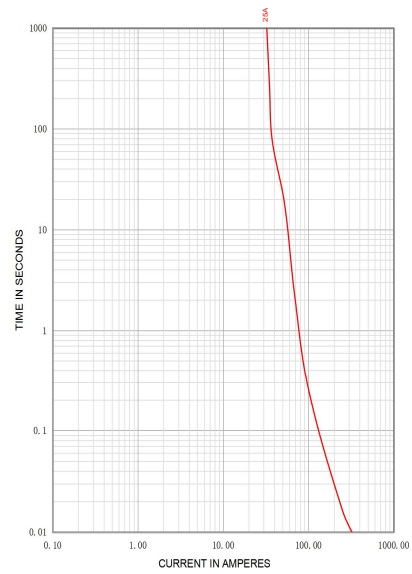

Time vs Current Characteristics: UL 248-14

Rated Current	100%	210%	275%	400%	1000%
25A	>1h	<30min	40ms~20s	10ms~1s	≤30ms



## Electrical Characteristics at 25°C

Amp Code	Rated Current	Rated Voltage	Cold Resistance value (mΩ)	Nominal Melting I <sup>2</sup> t (A <sup>2</sup> sec)	Breaking Capacity	Approvals	
						cURus	TUV
2500	25.00A	420V AC / DC	2.35~4.36	1031	300A@420V AC / DC	•	•

- Notes:** (1) Permissible continuous operating current is ≤100% at ambient temperature of 23°C (73.4°F)  
(2) Typical pre-arcing I<sup>2</sup>t are measured at 10I<sub>n</sub> current.

## Ordering Information

Series	Amp Code	Supplementary Code	Qty
529			